

**Approach for receiving pilot program volunteers arriving at YYC from
international Charter and General Aviation flights:
Alberta Border Testing Pilot Program**

Charter flights: Charter flights would be required to gate at the YYC international terminal and access CBSA, PHAC and the pilot program through the same route as those arriving on commercial flights. Pilots would then taxi the aircraft back to their private hangars. There would be no special shuttles or buses provided by the Airport Authority. The charter company would arrange any transportation to return to their hangar space after they cleared the pilot program. Charter flights means those charters that originate at a commercial passenger terminal and passengers clear security. For this program, charter flights do not include those private charters like sports teams that do not originate at a commercial passenger terminal but instead originate at private fixed base operations (FBOs) and would be considered general aviation flights.

General Aviation flights: Private aircraft would deplane at their hangar and complete the CBSA process. From the private hangar, the company would arrange a shuttle coordinated with the Airport Authority to the main terminal debussing at Bus Bay location 36 (map below), transportation to occur groundside (not across the airfield). Travellers would then enter the Terminal through arrivals doors 16 and join the line for the pilot program with the other passengers. There would be no special shuttles or buses provided by the Airport Authority, the private company would arrange transportation to return to their hangar space after the travellers clear the pilot program. Travellers would not be permitted to drive their personal vehicle from the private hanger and enter the terminal through the public entrance to access the program. This approach applies to charters like sports teams that do not originate at a commercial passenger terminal but instead originate at private fixed base operations.

In both cases, the passengers need to show their purple sheet to the AHS team in the terminal to participate in the testing program.

Prior to your travelers departing to the Terminal, please call the IOC on 403 735 1300 (then choose option 5)
state the flight details, number of travelers and an ETA to the drop off point at the airport.

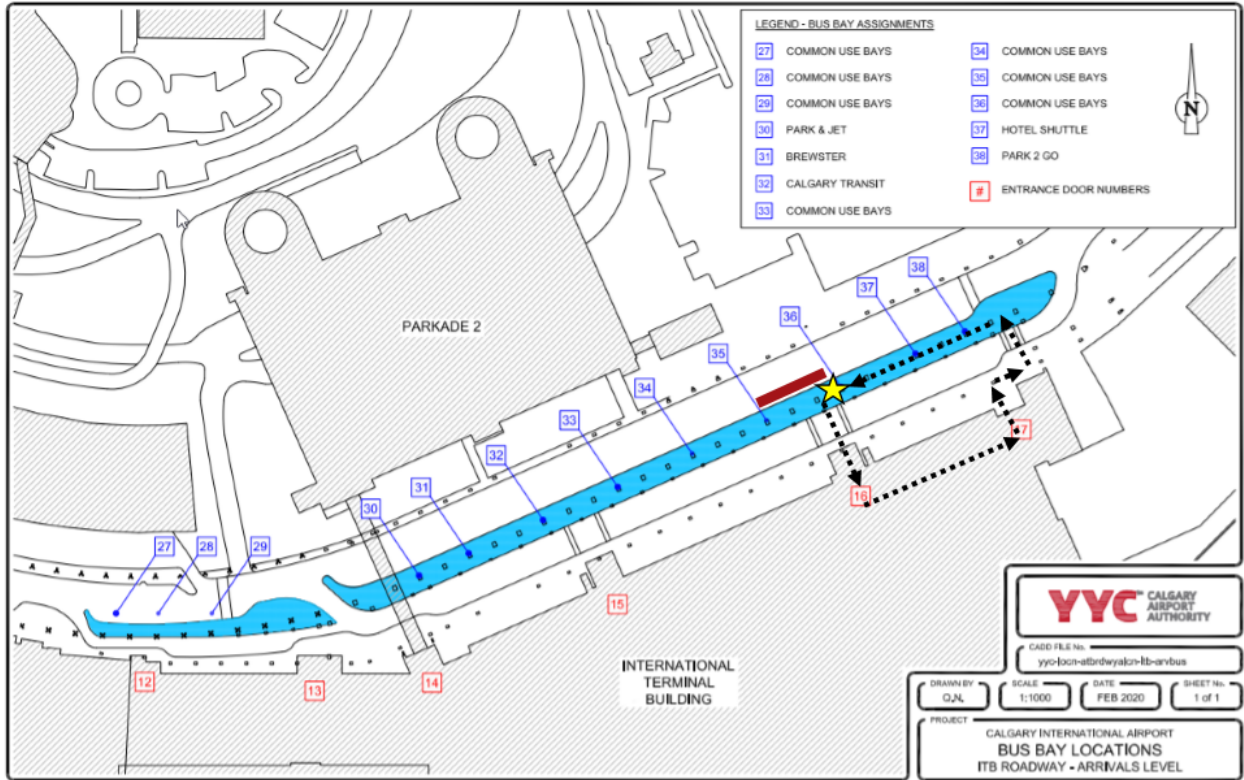

LEGEND - BUS BAY ASSIGNMENTS

- 27 COMMON USE BAYS
- 28 COMMON USE BAYS
- 29 COMMON USE BAYS
- 30 PARK & JET
- 31 BREWSTER
- 32 CALGARY TRANSIT
- 33 COMMON USE BAYS
- 34 COMMON USE BAYS
- 35 COMMON USE BAYS
- 36 COMMON USE BAYS
- 37 HOTEL SHUTTLE
- 38 PARK 2 GO
- # ENTRANCE DOOR NUMBERS



YYC CALGARY AIRPORT AUTHORITY

CADD FILE No.
yyc-ban-atbtdwyalon-lb-arrbus

DRAWN BY O.J.L.	SCALE 1:1000	DATE FEB 2020	SHEET No. 1 of 1
--------------------	-----------------	------------------	---------------------

PROJECT
CALGARY INTERNATIONAL AIRPORT
BUS BAY LOCATIONS
ITB ROADWAY - ARRIVALS LEVEL